



INSTALL GUIDE

OEM-AL(RS)-FM8-[FLCAN]-EN

DOCUMENT NUMBER
39797

REVISION DATE
20170526

FIRMWARE
OEM-AL(RS)-FM8-[FLCAN]

HARDWARE
FLCAN

ACCESSORIES
FLPROG (REQUIRED)



NOTICE The manufacturer will accept no responsibility for any electrical damage resulting from improper installation of this product, be that either damage to the vehicle itself or to the installed device. This device must be installed by a certified technician. Please review the Installation Guide carefully before beginning any work.



BEFORE INSTALLATION

- 1- Connect module to computer
- 2- Login to Weblink account
- 3- Flash firmware to module (module is not preloaded with firmware)
- 4- Use accessories accordingly (accessories are sold separately)



MAKE	MODEL	YEAR	INSTALL TYPE	FEATURES																
				DATA IMMOBILIZER BYPASS	3X LOCK START/STANDALONE MOD.	DOOR LOCK	DOOR UNLOCK	ARM OEM ALARM	DISARM OEM ALARM	TACHOMETER STATUS	HOOD STATUS OUTPUT*	BRAKE PEDAL STATUS OUTPUT	RAP SHUTDOWN CTRL	HEATED MIRRORS CTRL	HEATED SEATS CTRL	REAR DEFROST CTRL	TRUNK RELEASE	DOOR STATUS OUTPUT	TRUNK STATUS OUTPUT	POWER LIFTGATE
NOTES																				
I Vehicle must be equipped with an active OEM hood switch.																				
FORD	Edge STD key AT	15-17	1	•	•	•	•	•	•	•	•	•	•	•	•	•	•	•	•	•
	Edge PTS AT	15-17	1	•	•	•	•	•	•	•	•	•	•	•	•	•	•	•	•	•
	Explorer PTS AT	16-17	1	•	•	•	•	•	•	•	•	•	•	•	•	•	•	•	•	•
	F-150 STD key w/OEM Keyless Entry	15-17	1	•	•	•	•	•	•	•	•	•	•	•	•	•	•	•	•	•
	F-150 PTS AT	15-17	1	•	•	•	•	•	•	•	•	•	•	•	•	•	•	•	•	•
	F-250 / F-350 / F-450 STD key w/OEM Keyless Entry	17	1	•	•	•	•	•	•	•	•	•	•	•	•	•	•	•	•	•
	F-250 / F-350 / F-450 PTS AT	17	1	•	•	•	•	•	•	•	•	•	•	•	•	•	•	•	•	•
	Fusion STD key AT	14-17	1	•	•	•	•	•	•	•	•	•	•	•	•	•	•	•	•	•
	Fusion Hybrid STD key AT	14-17	1	•	•	•	•	•	•	•	•	•	•	•	•	•	•	•	•	•
	Fusion PTS AT	14-17	1	•	•	•	•	•	•	•	•	•	•	•	•	•	•	•	•	•
	Fusion Hybrid PTS AT	14-17	1	•	•	•	•	•	•	•	•	•	•	•	•	•	•	•	•	•
LINCOLN	Continental PTS AT	17	1	•	•	•	•	•	•	•	•	•	•	•	•	•	•	•	•	
	MKC PTS AT	15-17	1	•	•	•	•	•	•	•	•	•	•	•	•	•	•	•	•	
	MKZ PTS AT	14-17	1	•	•	•	•	•	•	•	•	•	•	•	•	•	•	•	•	
	MKZ Hybrid PTS AT	14-17	1	•	•	•	•	•	•	•	•	•	•	•	•	•	•	•	•	

*Available only if vehicle is equipped with factory hood switch.

BOX CONTENTS

MODULE

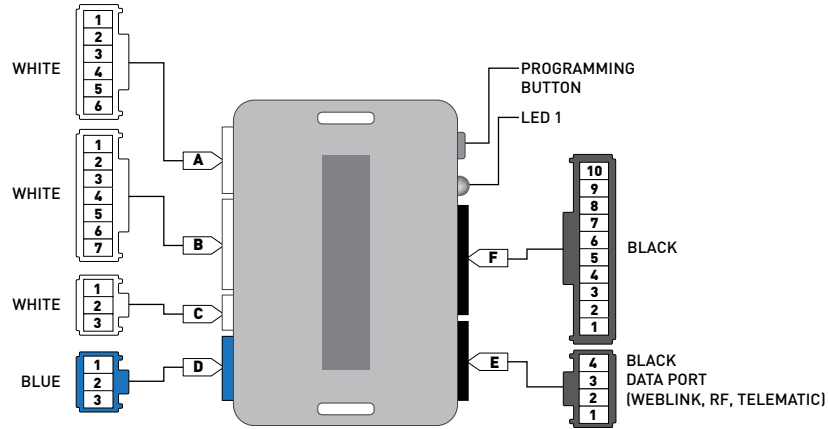

6 PIN WHITE CONNECTOR

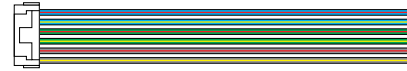

7 PIN WHITE CONNECTOR



3 PIN WHITE CONNECTOR



3 PIN BLUE CONNECTOR



4 PIN BLACK CONNECTOR



10 PIN BLACK CONNECTOR



DATA CABLE 1



DATA CABLE 2



WEBLINK CABLE (required accessory sold separately)

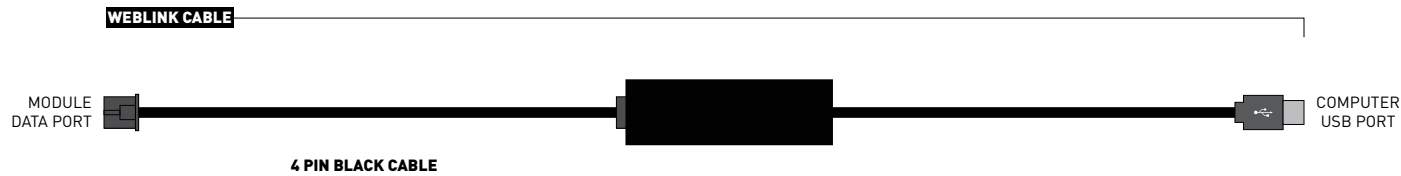

MAKE	MODEL	YEAR	WIRE DESCRIPTION	CONNECTOR NAME	CONNECTOR COLOR	CONNECTOR TYPE	POSITION	WIRE COLOR	POLARITY	MODULE LOCATION	COMPONENT LOCATOR
FORD	F-150 STD key w/OEM Keyless Entry / PTS AT	15-17	HS1 CanH	C2431	Black	24 pin	20	White/Blue	(DATA)	On Board Diagnostic module, driver side dash	~
			HS1 CanL	C2431	Black	24 pin	19	White	(DATA)	On Board Diagnostic module, driver side dash	~
			MS CanH	C2431	Black	24 pin	23	Gray/Orange	(DATA)	On Board Diagnostic module, driver side dash	~
			MS CanL	C2431	Black	24 pin	22	Purple/Orange	(DATA)	On Board Diagnostic module, driver side dash	~
			12V	C2431	Black	24 pin	24	Green/Red	(+)	On Board Diagnostic module, driver side dash	~
			Ground	C2431	Black	24 pin	14	Black/Purple	(-)	On Board Diagnostic module, driver side dash	~
			Parking light	C205	Black	16 pin	11	Gray	(-)	At parking lights switch	~
			RS enable	C205	Black	16 pin	04	Black/Purple	(-)	At parking lights switch	~
	F-250 / F-350 / F-450 STD key w/OEM Keyless Entry / PTS AT	17	HS1 CanH	C2431	Black	24 pin	20	White/Blue	(DATA)	On Board Diagnostic module, driver side dash	~
			HS1 CanL	C2431	Black	24 pin	19	White	(DATA)	On Board Diagnostic module, driver side dash	~
			MS CanH	C2431	Black	24 pin	23	Gray/Orange	(DATA)	On Board Diagnostic module, driver side dash	~
			MS CanL	C2431	Black	24 pin	22	Purple/Orange	(DATA)	On Board Diagnostic module, driver side dash	~
			12V	C2431	Black	24 pin	24	Green/Red	(+)	On Board Diagnostic module, driver side dash	~
			Ground	C2431	Black	24 pin	14	Black/Purple	(-)	On Board Diagnostic module, driver side dash	~
			Parking light	C205	Black	16 pin	11	Gray	(-)	At parking lights switch	~
			RS enable	C205	Black	16 pin	04	Black/Purple	(-)	At parking lights switch	~
	Edge STD key / PTS AT	15-17	HS1 CanH	C2431	Black	24 pin	20	Blue	(DATA)	Gateway module, right of steering column	~
			HS1 CanL	C2431	Black	24 pin	19	White	(DATA)	Gateway module, right of steering column	~
			MS CanH	C2431	Black	24 pin	23	Gray/Orange	(DATA)	Gateway module, right of steering column	~
			MS CanL	C2431	Black	24 pin	22	Purple/Orange	(DATA)	Gateway module, right of steering column	~
			12V	C2431	Black	24 pin	24	Gray/Red	(+)	Gateway module, right of steering column	~
			Ground	C2431	Black	24 pin	14	Black/Blue	(-)	Gateway module, right of steering column	~
			Parking light	C205	Black	16 pin	11	Gray	(-)	At parking lights switch	~
			RS enable	C205	Black	16 pin	04	Black/Blue	(-)	At parking lights switch	~
	Explorer PTS AT	16	HS1 CanH	C2431	Black	24 pin	20	White/Blue	(DATA)	On Board Diagnostic module, driver side dash	~
			HS1 CanL	C2431	Black	24 pin	19	White	(DATA)	On Board Diagnostic module, driver side dash	~
			MS CanH	C2431	Black	24 pin	23	Gray/Orange	(DATA)	On Board Diagnostic module, driver side dash	~
			MS CanL	C2431	Black	24 pin	22	Purple/Orange	(DATA)	On Board Diagnostic module, driver side dash	~
12V			C2431	Black	24 pin	24	Gray/Red	(+)	On Board Diagnostic module, driver side dash	~	
Ground			C2431	Black	24 pin	14	Black/Blue	(-)	On Board Diagnostic module, driver side dash	~	
Parking light			C205	Black	16 pin	11	Gray	(-)	At parking lights switch	~	
RS enable			C205	Black	16 pin	04	Black/White	(-)	At parking lights switch	~	

MAKE	MODEL	YEAR	WIRE DESCRIPTION	CONNECTOR NAME	CONNECTOR COLOR	CONNECTOR TYPE	POSITION	WIRE COLOR	POLARITY	MODULE LOCATION	COMPONENT LOCATOR
FORD	Fusion / Fusion Hybrid STD key / PTS AT	14-17	HS1 CanH	C2431	Black	24 pin	20	Blue	(DATA)	On Board Diagnostic module, driver side dash	~
			HS1 CanL	C2431	Black	24 pin	19	White	(DATA)	On Board Diagnostic module, driver side dash	~
			MS CanH	C2431	Black	24 pin	23	Gray/Orange	(DATA)	On Board Diagnostic module, driver side dash	~
			MS CanL	C2431	Black	24 pin	22	Purple/Orange	(DATA)	On Board Diagnostic module, driver side dash	~
			12V	C2431	Black	24 pin	24	Gray/Red	(+)	On Board Diagnostic module, driver side dash	~
			Ground	C2431	Black	24 pin	14	Black/Blue	(-)	On Board Diagnostic module, driver side dash	~
			Parking light	C205	Black	16 pin	11	Gray	(-)	At parking lights switch	~
			RS enable	C205	Black	16 pin	04	Black/Blue	(-)	At parking lights switch	~
LINCOLN	Continental PTS AT	17	HS1 CanH	C2431	Black	24 pin	20	Blue	(DATA)	On Board Diagnostic module, driver side dash	~
			HS1 CanL	C2431	Black	24 pin	19	White	(DATA)	On Board Diagnostic module, driver side dash	~
			MS CanH	C2431	Black	24 pin	23	Gray/Orange	(DATA)	On Board Diagnostic module, driver side dash	~
			MS CanL	C2431	Black	24 pin	22	White	(DATA)	On Board Diagnostic module, driver side dash	~
			12V	C2431	Black	24 pin	24	Gray/Red	(+)	On Board Diagnostic module, driver side dash	~
			Ground	C2431	Black	24 pin	14	Black/Blue	(-)	On Board Diagnostic module, driver side dash	~
			Parking light	C205	Black	16 pin	11	Gray	(-)	At parking lights switch	~
			RS enable	C205	Black	16 pin	04	Black/Blue	(-)	At parking lights switch	~
LINCOLN	MKC PTS AT	15-17	HS1 CanH	C2431	Black	24 pin	20	White/Blue	(DATA)	On Board Diagnostic module, driver side dash	~
			HS1 CanL	C2431	Black	24 pin	19	White	(DATA)	On Board Diagnostic module, driver side dash	~
			MS CanH	C2431	Black	24 pin	23	Gray/Orange	(DATA)	On Board Diagnostic module, driver side dash	~
			MS CanL	C2431	Black	24 pin	22	Purple/Orange	(DATA)	On Board Diagnostic module, driver side dash	~
			12V	C2431	Black	24 pin	24	Gray/Red	(+)	On Board Diagnostic module, driver side dash	~
			Ground	C2431	Black	24 pin	14	Black	(-)	On Board Diagnostic module, driver side dash	~
			Parking light	C205	Black	16 pin	11	Gray	(-)	At parking lights switch	~
			RS enable	C205	Black	16 pin	04	Black/Purple	(-)	At parking lights switch	~
LINCOLN	MKZ / MKZ Hybrid PTS AT	14-16	HS1 CanH	C2431	Black	24 pin	20	Blue	(DATA)	On Board Diagnostic module, driver side dash	~
			HS1 CanL	C2431	Black	24 pin	19	White	(DATA)	On Board Diagnostic module, driver side dash	~
			MS CanH	C2431	Black	24 pin	23	Gray/Orange	(DATA)	On Board Diagnostic module, driver side dash	~
			MS CanL	C2431	Black	24 pin	22	Purple/Orange	(DATA)	On Board Diagnostic module, driver side dash	~
			12V	C2431	Black	24 pin	24	Gray/Red	(+)	On Board Diagnostic module, driver side dash	~
			Ground	C2431	Black	24 pin	14	Black/Blue	(-)	On Board Diagnostic module, driver side dash	~
			Parking light	C205	Black	16 pin	11	Gray	(-)	At parking lights switch	~
			RS enable	C205	Black	16 pin	04	Black/Blue	(-)	At parking lights switch	~

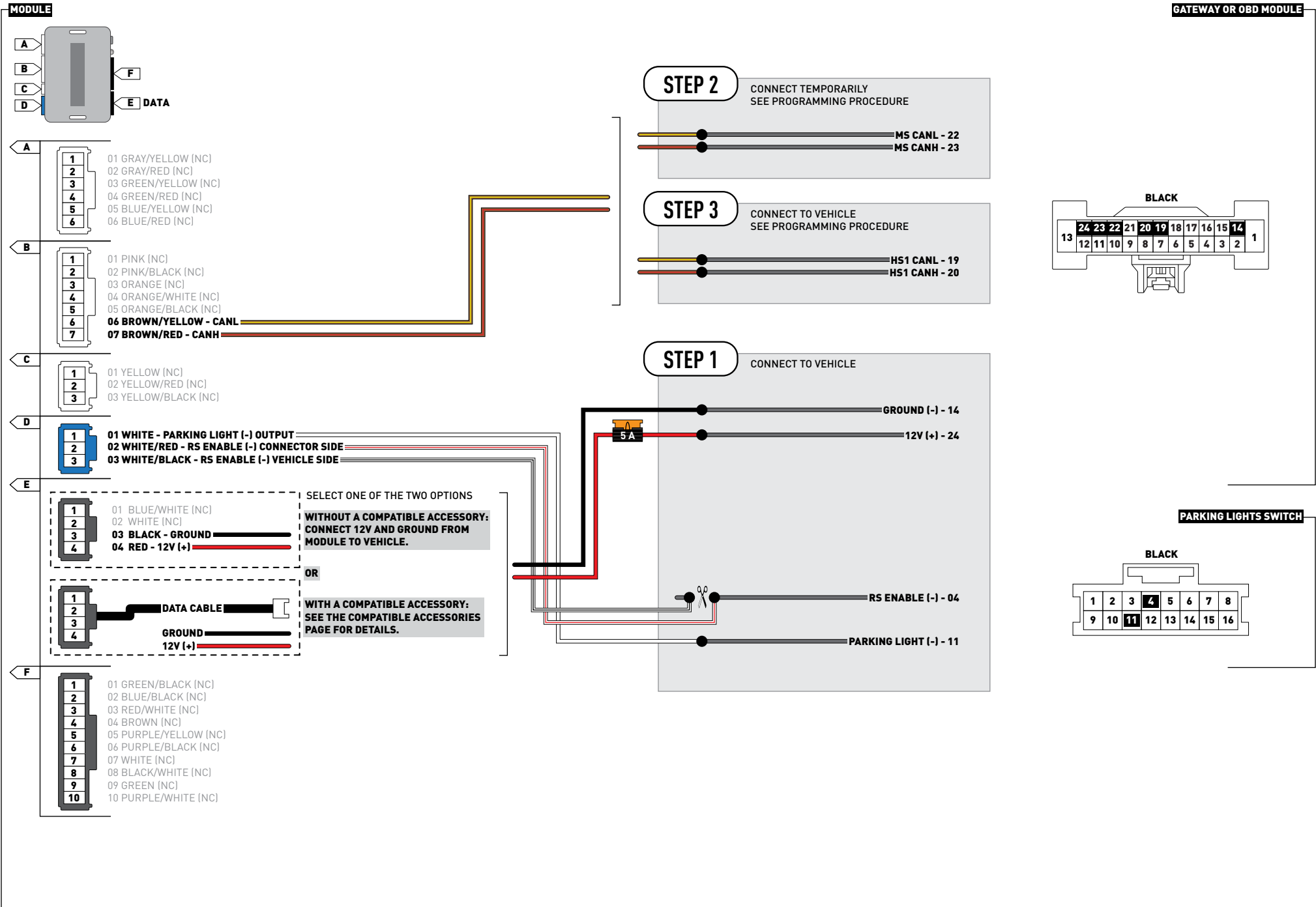

01 CONNECT every wire shown in STEP 1 and STEP 2 of the wiring diagram.



02 Set ignition to ON position.



03 Wait, LED 1 will turn solid RED.



04 Wait, LED 1 will flash GREEN once [1x].



05 Wait, LED 1 will turn solid RED.



06 Set ignition to OFF position.



07 DISCONNECT every wire shown in STEP 2 and CONNECT every wire shown in STEP 3 of the wiring diagram.



08 Set ignition to ON position.



09 Wait, LED 1 will turn solid RED.



10 Wait, LED 1 will flash GREEN rapidly.



11 Wait, LED 1 will turn solid GREEN for 2 seconds.



12 Set ignition to OFF position.



13 Module Programming Procedure completed.

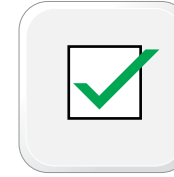

>>



NOTE: In Valet Mode, the Remote starter is not functional. Keyless entry, Lock and Unlock will remain functional. See RF kit user manual for alternate valet mode programming.

01



Time restriction. Complete next step within 7 seconds.

02



Cycle ignition ON five times [5x OFF/ON] rapidly.

03

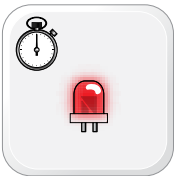

Wait, LED 1 will turn solid RED for 2 seconds.

04



Set ignition to OFF position.

05





Valet Mode Programming Procedure completed.

>>



To exit valet mode: repeat steps 1 to 5.

>>  It is mandatory to exit the Module Navigation at the end of this procedure. Failure to exit the Module Navigation will drain vehicle battery. To exit the Module Navigation at any time: Follow STEP 13.

>>  Module must be programmed to the vehicle.

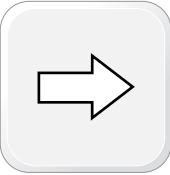
>>  Use the Module Navigation Chart on the next page.

01  Set ignition to OFF position.

02  TO ACCESS THE MENUS: Press and hold programming button until LED 1 turns solid GREEN.

03  IN THE MENUS: Press the programming button as many times as the menu number indicates. LED 1 will flash GREEN an equal amount of times continuously.

04  TO ACCESS THE OPTIONS: Press and hold programming button until LED 1 turns solid RED.

05  IN THE OPTIONS: Press the programming button as many times as the option number indicates. LED 1 will flash RED an equal amount of times continuously.

06  TO ACCESS THE SETTINGS: Press and hold programming button until LED 1 turns solid GREEN.

07  LED 1 will flash GREEN as many times as the current (or default) setting number, continuously.

08  IN THE SETTINGS: Press the programming button as many times as necessary to access your setting. LED 1 will flash GREEN an equal amount of times continuously.

09  To return to the MENUS: exit the Module Navigation and redo the Module Navigation Procedure.

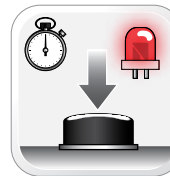
10  To save and return to the OPTIONS: Press and hold programming button until LED 1 turns solid RED.

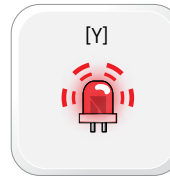
11  LED 1 will flash RED as many times as the current option number continuously.

12  Configure every other setting and proceed to step 13.

13  MANDATORY: EXIT MODULE NAVIGATION. Press and hold programming button for 7 seconds. LED 1 will flash RED rapidly. Release programming button. LED 1 will turn OFF.

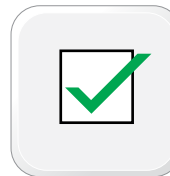
14  Module navigation completed.

>>  Failure to exit the Module Navigation will drain vehicle battery.

MODULE NAVIGATION CHART: NOTES	[X] MENUS		[Y] OPTIONS		[Z] SETTINGS	
I Default settings are listed in bold. II Make sure the option is covered on the vehicle before attempting to change the setting.	01	CONFIGURATION	01-04	N/A	01	N/A
			05	TAKEOVER	01	ENABLE
			06	N/A	02	DISABLE*
			07	FACTORY KEYLESS RS SEQUENCE	01	N/A
					01	DISABLE
					02	N/A
					03	LOCK + UNLOCK + LOCK
					04	LOCK + LOCK + LOCK
					01	03 MIN
					02	05 MIN
					03	10 MIN
					04	15 MIN
					05	25 MIN**
		06	30 MIN**			
		07	35 MIN**			
		08	15 MIN			
09-12	N/A	01	N/A			
02-07	Technical Support only	01	N/A			

*Vehicle will shutdown when a door is opened.

**The maximum runtime for 2013 models is 2 x 10 minutes or 1 x 15 minutes.

REMOTE STARTER ERROR CODES: NOTES	[X] NUMBER OF PARKING LIGHT FLASHES	DIAGNOSTIC
I WARNING: The following applies only when the parking lights are connected and supported by the system.	03	Foot brake is ON.
	04	Hood is open.
II After a remote starter failure, the parking lights will flash [X] number times to indicate an error code. See table.	05	Engine tach signal is lost.
	06	System is in Valet Mode.
	07	Vehicle is moving (VSS).
	08	Glow plug timeout error.

TEST MODULE		LED 1 STATUS	DIAGNOSTIC
I	DURING PROGRAMMING	Flashing RED	Missing/wrong information from firmware or vehicle.
		Solid RED	Module waiting for more vehicle information.
		Flashing GREEN	Additional steps required to complete module programming.
		Solid GREEN then OFF	Module correctly programmed.
		OFF	No activity or module already programmed.
II	DURING REMOTE START	Flashing RED	Module incorrectly programmed.
		Solid RED	Module incorrectly programmed.
		Flashing GREEN	Module correctly programmed and operational.
		Solid GREEN then OFF	Reset in progress.
		OFF	Invalid ground when running status from remote starter.
III	WITH IGNITION OFF	Flashing RED	Module incorrectly programmed or connected.
		Solid RED	Module not programmed. Waiting for more vehicle information.
		Flashing GREEN	False ground when running status from remote starter.
		Solid GREEN then OFF	Reset in progress.
		OFF	Module at rest and ready for a remote start sequence.

01 Disconnect all connectors from module except the BLACK 4-PIN connector.

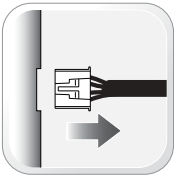

02 Disconnect the BLACK 4-PIN connector.

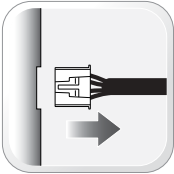

03 PRESS AND HOLD programming button while connecting the BLACK 4-PIN connector.



04 Wait, LED 1 will flash RED. RELEASE programming button.



05 LED 1 will turn RED for 2 seconds.

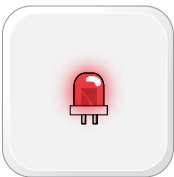

06 Module RESET completed.



07 Reconnect all connectors.

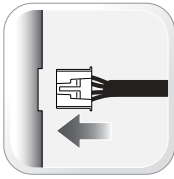

08 Repeat programming procedure.



>> Failure to follow procedure may result with a DTC or a CHECK ENGINE error message.



>>



All vehicle doors must be closed and locked prior to remote start sequence.

01



Press unlock on OEM or aftermarket remote or request switch.

02



DO NOT PRESS BRAKE PEDAL. Set ignition to ON position. Wait 2 seconds for key validation.

03



Press and release BRAKE pedal.

04



Take over procedure completed.

>>



Failure to follow procedure will result in vehicle engine shutdown.

CHECKLIST	
1	WARNING: Vehicle engine will start many times. Test in a well ventilated area.
2	Close all vehicle doors, hood and trunk.
3	Press LOCK button three times [3x] rapidly on the OEM keyfob to remote start vehicle.
	Question 1: Does the vehicle remote start?
<input type="checkbox"/>	YES: Go to next step.
<input type="checkbox"/>	NO: The module doesn't detect OEM remote lock button from the vehicle communication network. Check all connections, repeat the test and call technical support, if the problem persists.
4	Press LOCK button three times [3x] rapidly on the OEM keyfob to shut down vehicle.
	Question 2: Does the vehicle shut down?
<input type="checkbox"/>	YES: Go to next step.
<input type="checkbox"/>	NO: Repeat step. If the problem persists, press on the brake pedal once [1x] to shut down the vehicle and call technical support.
5	RAP Shutdown test
	Question 3: Did the radio, interior controls, and headlights turn off within 60 seconds after remote start shutdown?
<input type="checkbox"/>	YES: Go to next step.
<input type="checkbox"/>	NO: Verify the RAP SHUTDOWN connections as illustrated in the wiring diagram. Repeat the test and call technical support, if the problem persists.
6	Open hood.
7	If not already installed, affix the mandatory orange warning sticker under the hood and proceed to next step.
8	Press LOCK button three times [3x] rapidly on the OEM keyfob to remote start vehicle.
	Question 4: Does the vehicle remote start?
<input type="checkbox"/>	YES: The vehicle is not equipped with a factory hood pin. Install a mandatory aftermarket hood switch, then repeat the test.
<input type="checkbox"/>	NO: Go to next step.
9	Close hood.
10	Enter vehicle and close the doors.
11	Press LOCK button three times [3x] rapidly on the OEM keyfob to remote start vehicle.
12	Wait for the vehicle to start.
13	Press brake pedal.
	Question 5: Does the vehicle shut down?
<input type="checkbox"/>	YES: Go to next step.
<input type="checkbox"/>	NO: The module does NOT detect the brake pedal signal. Press LOCK button three times [3x] rapidly on the OEM keyfob to shut down, check the brake connection as illustrated in the wiring diagram, if applicable, and call technical support.
14	Exit vehicle.
15	Installation checklist completed.